

SEE TTC-00(A), TTC-00(B) AND TTC-00(C)

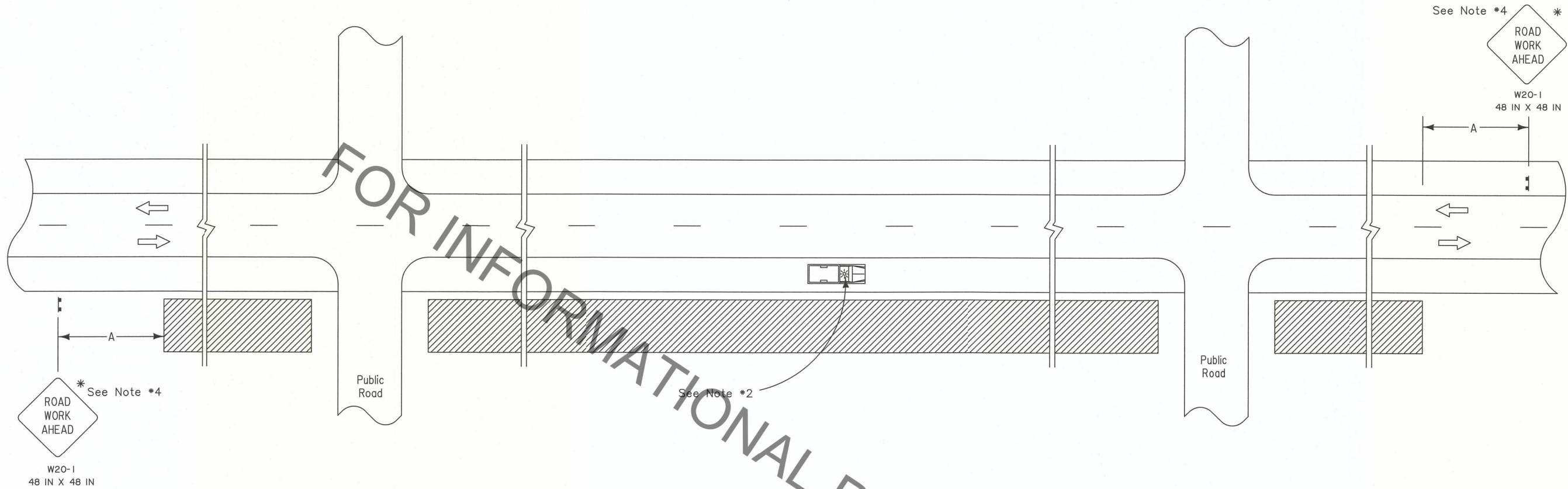

LEGEND

- Traffic Sign
- Work Area
- Direction of Travel
- Truck with Amber Light

SPEED LIMIT (prior to construction)	SPACING
	'A'
≤ 40 mph	500 FT
45-50 mph	1000 FT
≥ 55 mph	1500 FT

NOTES

This sheet shall be used with the Temporary Traffic Control General Notes Sheets TTC-00(A), TTC-00(B) and TTC-00(C).

1. This layout represents the minimum traffic controls required for workers and equipment operating more than 15 feet from the travel way.
2. If the operation results in equipment or other vehicles being parked closer than 15 feet to the travelway, but not within the roadway, each vehicle shall have an amber light.
3. When a work area has been established on one side of the roadway only, there shall be no parking on the opposite shoulder within 500 feet of the work area.
4. Other signs may be used in place of the "Road Work Ahead" sign, such as W21-8 (Mowing), W21-7 (Utility), or W21-6 (Survey) when applicable.

* Any sign of the W20-1 series may be used.

ALL TTC STANDARDS SHOW MINIMUM CONSTRUCTION SIGNING.
ALL SITUATIONS SHALL BE REVIEWED AND/OR DESIGNED BY THE ENGINEER.
CONTRACTORS ARE RESPONSIBLE FOR COMPLYING WITH ALL TTC STANDARDS.



SHEET NUMBER	
DESIGNED G. LEBLANC	PARISH
CHECKED J. COLVIN	CONTROL SECTION
DATE	STATE PROJECT
REVISION OR CHANGE ORDER DESCRIPTION	BY
NO.	DATE
APPROVED BY	DATE
CHIEF ENGINEER	



TEMPORARY TRAFFIC CONTROL FOR WORK GREATER THAN 15 FEET FROM THE TRAVELLED WAY
TTC-01

